



Charge Valve

Charge valves are mainly installed in air conditioning and refrigeration systems. They are used as service valve for circuit evacuation to vacuum and for refrigerant injection.



FEATURES

- SIMPLE STRUCTURE, CONVENIENT TO USE
- PREVENT REFRIGERANT LOSS THROUGH INTEGRATED SHRADER VALVE

GENERAL SPEC.

- Applicable for all common HCFC and HFC refrigerants such as: R22, R134a, R404A, R407C, R410A, R507
- TS min./max.: -30°C / +80°C
- PS: 4,2 MPa
- Certifications: PED

DIMENSIONS

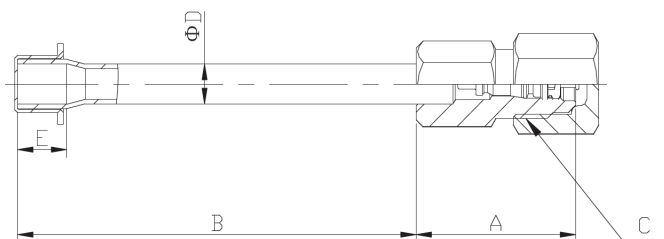

Model	Product number	A	B	C	Refrigerant	D		E
		mm	mm	in		mm	in	mm
TCJ-2HMSZ-1	TCJ14001	26	65	7/16-20UNF	R22	6,35	1/4	8
TCJ-2GMS-1	TCJ14002	26	65	1/2-20UNF	R407C/R410A	6,35	1/4	8

