

GENERAL DATA

Application:	LBP
Refrigerant:	R404A
Expansion Device:	C-V
Weight:	23.8 kg
Receiver:	1.1 liter
Voltage/Frequency:	220 - 240 V 50 ~
Height:	23.8 mm
Length:	499 mm
Width:	340 mm
Institute Approvals:	CE

EXTERNAL DIMENSIONS

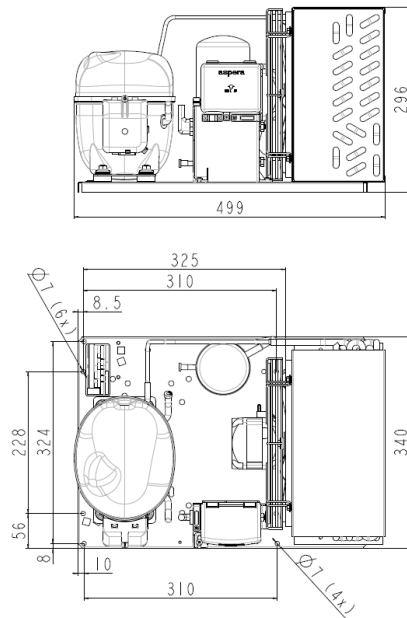

WIRING DIAGRAM

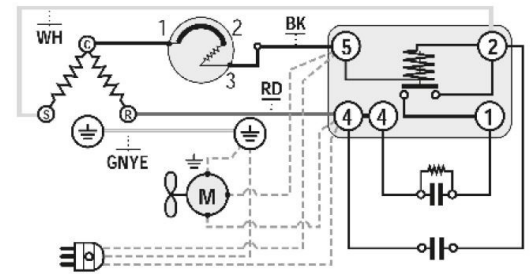

OPERATING ENVELOPE

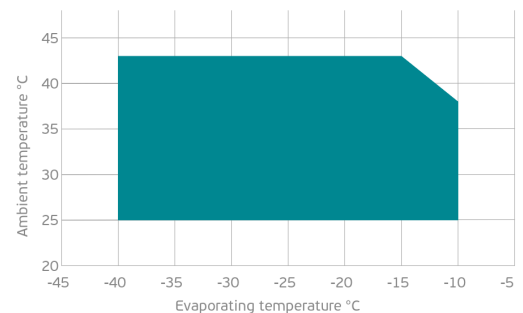

COMPONENTS (SPARE PARTS)

condenser:	4R11T	2451217
compressor:	NEK2168GK	959HA51...AM

fankit:	16W 254/28/5B	1996609
elkit:	ELKOM NEK2168GK	959HA5190A

For additional accessories please contact our technical support

ELECTRICAL DATA

Motor Type: CSR -
 Locked Rotor Amperage (LRA): 18.5 A
 Max.Current: 4.2 A

At maximum evaporating temperature and maximum ambient temperature.

FAN MOTOR

Number: 1 -
 Shaft Power: 16 W
 Air Flow: 460 m³/h
 Blade Diameter: 254 mm

PERFORMANCE CURVE DATA

Standard: EN13215-RG20 / return gas 20°C, subcooling 3K

50 Hz

	Evaporating Temperature (°C)	Cooling Capacity (W)	Power Consumption (W)	Current Consumption (A)	Efficiency (W/W)
25 °C Ambient Temperature	-10°C	1 312	706	0.00	1.86
	-15°C	1 114	640	0.00	1.74
	-20°C	923	582	0.00	1.59
	-25°C	747	530	0.00	1.41
	-30°C	594	482	0.00	1.23
	Rated point -35°C	472	438	0.00	1.08
	-40°C	391	396	0.00	0.99
32 °C Ambient Temperature	-10°C	1 179	739	0.00	1.59
	-15°C	996	666	0.00	1.49
	-20°C	819	601	0.00	1.36
	-25°C	658	541	0.00	1.22
	-30°C	520	487	0.00	1.07
	Rated point -35°C	415	435	0.00	0.95
	-40°C	349	387	0.00	0.90
43 °C Ambient Temperature	-15°C	820	706	0.00	1.16
	-20°C	672	633	0.00	1.06
	-25°C	539	567	0.00	0.95
	-30°C	430	505	0.00	0.85
	Rated point -35°C	354	448	0.00	0.79
	-40°C	319	393	0.00	0.81